

LEGEND

29 KEY SHEET
123 DETAIL SHEET NUMBER
 BLOCK LIMIT
 SHEET LIMIT
 BLOCK LIMIT
1.02 DETAIL SHEETS
2 BLOCK NUMBER
 LOT NUMBER

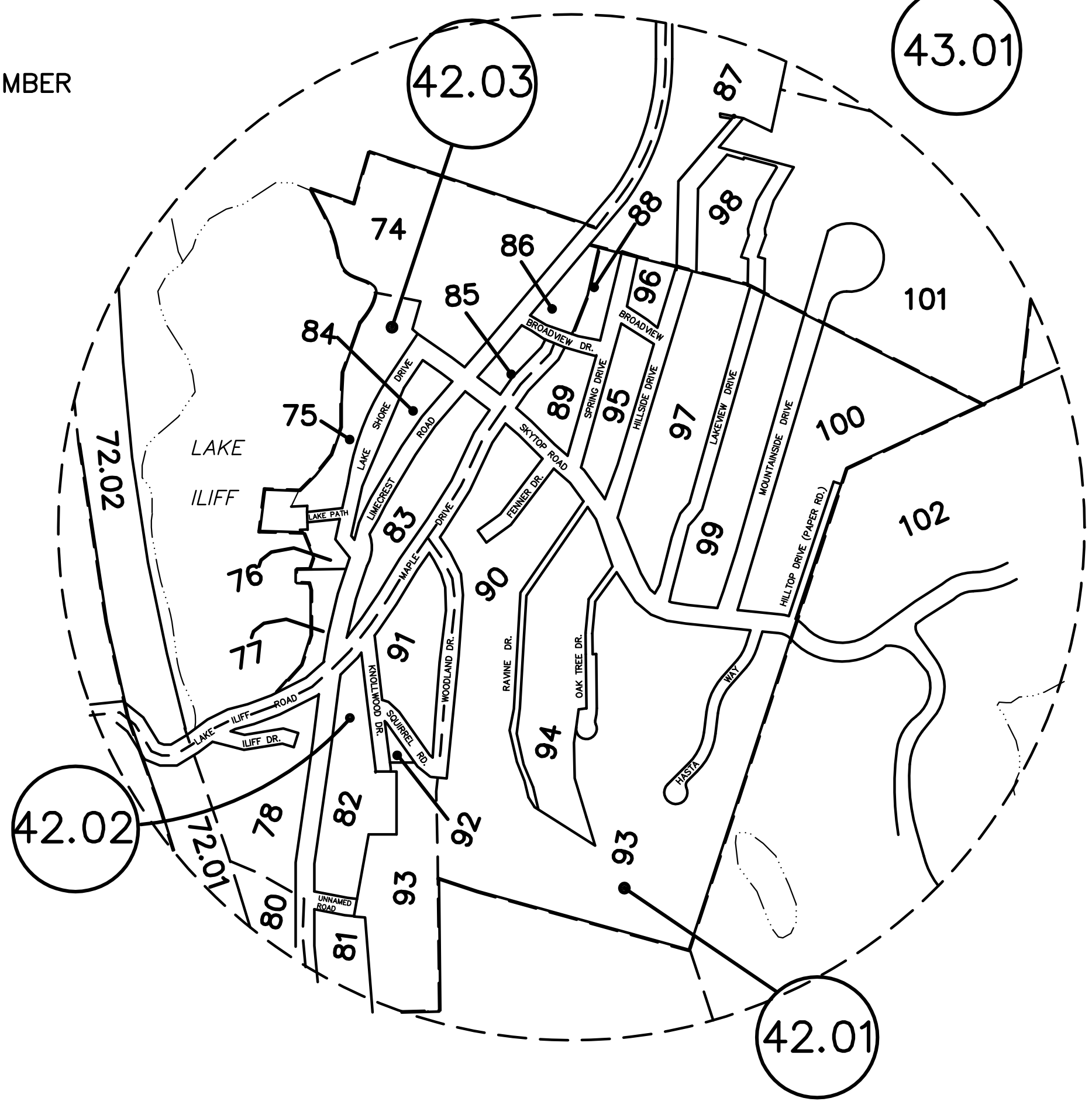

INSET
SCALE: 1" = 500'

| REVISIONS | | |
|-----------|------|-------------|
| DATE | NAME | LICENSE NO. |
| | | |
| | | |

I HEREBY CERTIFY THAT THIS MAP HAS BEEN MADE UNDER MY IMMEDIATE SUPERVISION, AND COMPLIES WITH THE LAWS OF THE STATE OF NEW JERSEY.

William F. Stoehr 8/1/15
 WILLIAM F. STOHR, N.J.L.S. NO. GS27890 DATE

NOTE:
 THE AREAS, BOUNDARIES AND DIMENSIONS SHOWN ON THIS TAX MAP ARE DERIVED FROM GROUND SURVEYS, AERIAL SURVEYS, AND RECORDED PLANS, MAPS, DEEDS, WILLS, AND ARE TO BE USED FOR ASSESSMENT PURPOSES ONLY.

NOTE:
 THIS MAP HAS BEEN REDRAWN USING COMPUTER AIDED DRAFTING/DESIGN (CAD/D) BASED ON THE MAP PREPARED BY DANIEL E. KENT, III N.J.L.S. NO. 14818 ON APRIL 1999.

NOTE:
 THIS TAX MAP SUPERSEDES THE TAX MAP APPROVED 11/18/02.

TAX MAP
TOWNSHIP OF ANDOVER
 SUSSEX COUNTY, NEW JERSEY
 SCALE: 1"=1000' DATE: JANUARY 2014
WILLIAM F. STOHR
 PROFESSIONAL LAND SURVEYOR No. GS27890
 129 LINCOLNDALE ACRES
 WASHINGTONVILLE, NY 10992
 TO SHOW CONDITIONS AS OF 11/01/2013

KEY MAP 1.01